

Brilliant

USER MANUAL

B300

INTRODUCTION

Congratulations on purchasing the Brilliant B300 electric file! You have invested in high-quality equipment to set yourself up for success! Please be sure to read this user manual to ensure you get the most out of this machine. Use the hand piece with light, gentle pressure for optimal client comfort.

Pay close attention the contents with marks such as 

Design and specification of the product is subject to change without notice for improvements purposes.

FEATURES

- Max. 30,000 RPM
- Powerful torque
- Rotation switch (Forward/Neutral/Reverse)
- Easy to use speed slider
- Digital RPM display
- Use bits with a standard shaft size of 3/32 in
- Twist collet-chuck to secure bits
- Light weight 4.6 oz hand piece and motor
- Convenient USB port
- 110-220V Switch
- For professional use only

USER GUIDELINES

WARNING

- The B300 handpiece should be only used with the B300 control box.
- Stop the motor before changing rotary direction.
- Stop the motor before changing bits.
- Do not turn on while the hand piece is unlocked.
- Check to make sure the switch is OFF before plugging the power cord into an outlet.
- Do not use with a bent bit. It will damage the hand piece.
- Do not put the hand piece down until it stops completely.
- Do not unlock the hand piece while operating.
- Avoid wearing loose clothing and jewelry when operating this unit. Long hair should be secured and kept away to prevent injury.
- Be careful not to drop the hand piece as it may be damaged. If dropped, check if the bit is bent or if excessive heat is generated while using it.
- If any problem occurs, seek service and repair from an authorized service agent.
- This device should be serviced regularly by an authorized agent to ensure safety and optimum performance.
- Do not work in a dangerous place.
- Use accessories suitable for this product.
- Wear proper protective clothes & equipment, including a dust mask & safety goggles.
- Do not use the unit if any flaws are observed (frayed power cord, irregular vibration, etc.)
- Discontinue use immediately and contact SAESHIN PRECISION.
- Keep the workplace clean. Debris may cause an accident.
- Do not touch the hand piece, the unit, or its cords and connectors with wet hands.
- Do not bend the cords excessively. This may cause electric shock or fire or short in cord.
- If using an outlet power strip, do not overload. This may cause fire or electric shock.
- If the supply cord is damaged, it must be replaced by the manufacturer, its service agent or similarly qualified persons in order to avoid a hazard.
- This unit is NOT a toy. Keep children away from this unit at all times.
- Use with specified input voltage.
- Turn off control box when not in use

PRODUCT COMPONENTS

* Please check all components are included.

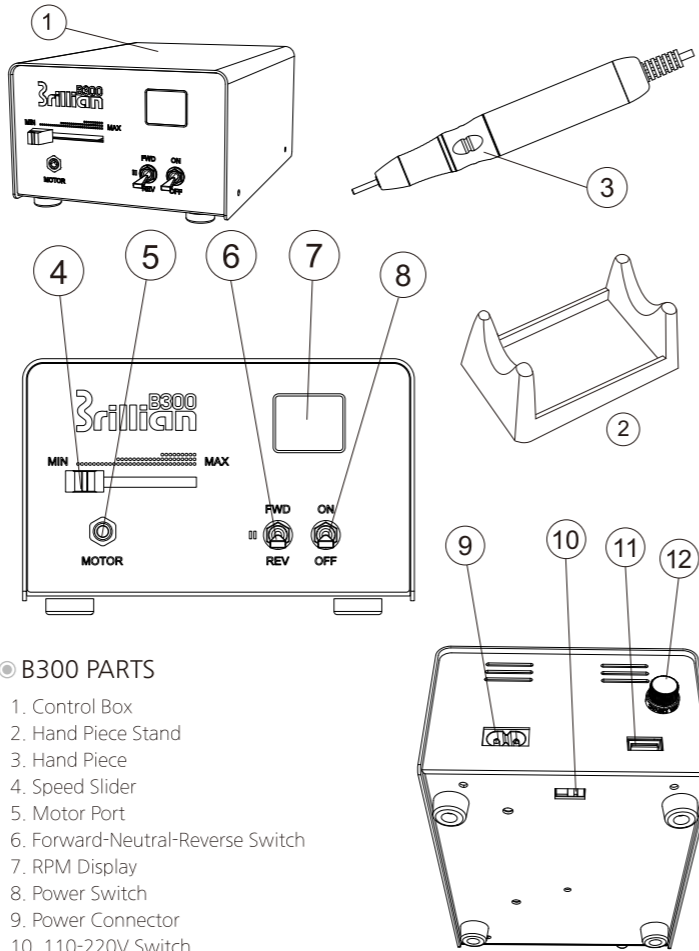

B300 PARTS

1. Control Box
2. Hand Piece Stand
3. Hand Piece
4. Speed Slider
5. Motor Port
6. Forward-Neutral-Reverse Switch
7. RPM Display
8. Power Switch
9. Power Connector
10. 110-220V Switch
11. USB Port
12. Fuse Holder

CONNECTION OF EACH PART

Control Box

1. Connect the hand piece to the motor port.
2. Turn the power on by switching the power switch up.
3. Choose the rotary direction with the FWD-N-REV switch.
4. Stop the rotary direction by moving FWD-N-REV switch to the center (pause).

Bur Insertion

1. Turn the handle to open the handpiece chuck.



2. Insert the bur in the front of handpiece.

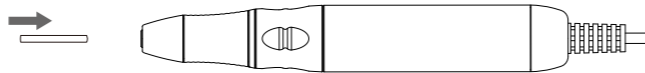

3. Lock the handpiece chuck by turning the handle.



- Never operate without a bit properly locked in hand piece.
- Stop the motor before changing rotary direction or bits.
- Do not use with bent bits.
- Use with bit shaft diameter 3/32 in. and min. length 10 mm.

OPERATION PROCESS

1. Turn the power on by turning the Power Switch up.
2. Flip the FWD-N-REV Switch up or down to choose direction.
3. Set the speed with the Speed Slider.
 - Move Slider to the right to increase speed.
 - Actual RPM (revolutions per minute) is 1,000 times the number on display.
4. Stop the motor by flipping FWD-N-REV switch to the center (pause).
5. Power is turned off when the Power Switch is down (OFF).
6. To unlock the hand piece, twist the ring set on the hand pieceright until a click is heard. In this position, bits may be removed or inserted into the hand piece.
7. Insert a bit and lock the hand piece by twisting the ring set to the left completely. Dots should be aligned.

USB PORT

The USB Port only supplies power when the control box is powered ON.
Tip: Keep the Control Box in NEUTRAL and the power ON to charge small electronics when not using the electric file.

PROBLEM & REMEDEY

If the product does not work after checking, please contact SAESHIN PRECISION.

Control Box

Problem	Check	Cause	Solution
The motor does not run.	The power is out.	The control box may have a problem.	Check the fuse.
	The powerlight is out when the power switch is on.	Check the connection of the power cord.	Connect the power cord properly.
	The hand piece does not run, when the power switch is on and power light is on.	Check connection of HP at motor port. Check if cord is worn down or disconnected.	Connect hand piece properly. Seek maintenance.
The motor runs.	Speed control is out.	The control box may	Seek maintenance.

Handpiece

Problem	Cause	Solution
The hand piece does not run, although the chuck is locked.	Check the connection of the HP and control box.	Connect the HP cord and power cord properly.
The hand piece is getting warm during use.	Bearing may be worn down.	Seek maintenance.
There's noise and vibration during use.	Bearing may be worn down.	Seek maintenance.
	Check if the bit is bent.	Change the bit.

REPLACEMENT OF FUSE

The fuse is in a small fuse box beside the power connector on the back of the control box
Pull out the fuse box then replace it with a new one.
(120V-T3.15A/250V, 230V-T2A/250V)

PRODUCT SPECIFICATION

Control Box

Model Name	B300
Input	AC 110 V, 50/60 Hz / AC 220 V, 50/60 Hz
Fuse	DC 24V, 2A
Mode of Operation	Continuous

Handpiece

Model Name	POHPK
RPM	30,000 rpm
Torque	3.5N.cm

MAINTENANCE

- ① Keep the hand piece and its environment clear of debris.
- ② Remove debris from the hand piece with a wire or nylon brush before changing bits.
- ③ Always use a clean, dry bit in the hand piece. Wet bits will rust the inside.
 - NEVER apply oil or water to any part of the unit.
 - Liquids inside the hand piece will cause damage.
- ④ Air cleaning is acceptable but do not clean with air pressure.
- ⑤ Store the hand piece with a bit locked in to prevent debris getting inside the chuck.

Warranty

SAESHIN guarantees this product for 1 year from invoice date. Product warranty means that SAESHIN has responsibility for defective material or operation failure. The product warranty does not cover user's misuse, wrong installation, inappropriate maintenance and repair, and normal wear of consumables such as bearings, spindle, gear, and rotator. In order for Saeshin to confirm if the warranty is valid will require checking the operating condition, environment information, serial number and stamped invoice. The warranty will be performed as a repair or exchange according to manufacturer's analysis of product and judgement.
Exception of warranty

Any misuse or improper use and treatment of product

Using the product with incorrect input voltage (AC voltage)

Dropping the unit during setting or moving

Use not recommended consumables or accessories

Malfunction after repairing the product at an unauthorized repair shop

Normal wear of consumables: such as ball bearings, gear, chuck, spindle case assy, motor

Any Act of God

Operating condition	Temperature (℃)	10~30
	Relative humidity (%)	10~80
	Atmospheric pressure (hPa)	700~1,060
Transport and Storage condition	Temperature (℃)	-20~60
	Relative humidity (%)	10~90
	Atmospheric pressure (hPa)	500~1,060



SAESHIN
SAESHIN PRECISION CO., LTD.

52, Secheon-ro 1-gil, Dasa-eup,
Dalseong-gun, Daegu, Korea
Tel. 82-53-587-2341 / Fax. 82-53-580-0999
대구광역시 달성군 다사읍 세천로 1길 52(성서5차산업단지)
Tel. 053-587-2345 / Fax. 053-580-0918

www.saeshin.com / traus@saeshin.com

SOM-L0825-E [Rev.0] 2021-03-04